



INSTALLATION

- 1) Drill a small hole into a solid object, such as a post, beam, or hitch rail.
- 2) Screw in the Eye Bolt until secure and the ring of the Eye Bolt rests horizontally.
- 3) Attach the Quick Snap to the smaller ring of the Tie Ring and clip to the Eye Bolt so the tongue of the Tie Ring curves back toward the post when hanging.

LEVEL 1 (MINIMUM HOLD)

STEP 1 After installing the Aussie Tie Ring 2, double-up the lead rope* approximately three feet from the snap end and make a loop. Insert the loop through the large ring of the Tie Ring. Next, push the tongue of the Tie Ring up through the loop in the rope until the magnet engages.

* The lead rope should be at least 10 feet long to allow enough slack. The suggested length of lead rope between your horse and the Aussie Tie Ring 2 during its use is approximately three feet. You may need more or less depending on your horse.

STEP 2 Pull both ends of the lead rope straight down to secure in place. The tongue will make contact with the magnet and secure the rope in place. Be sure to practice a few times before attempting with your horse.

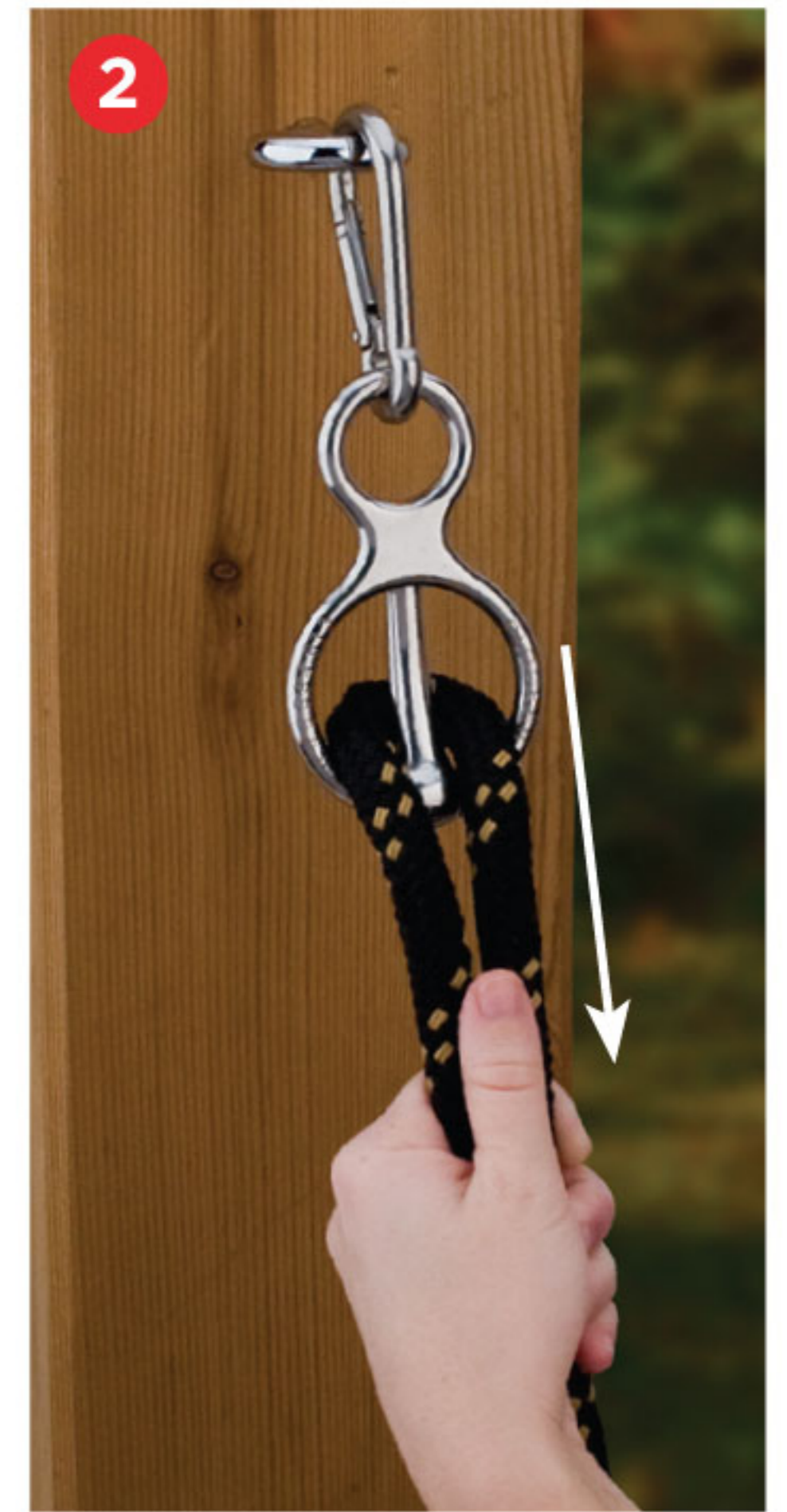
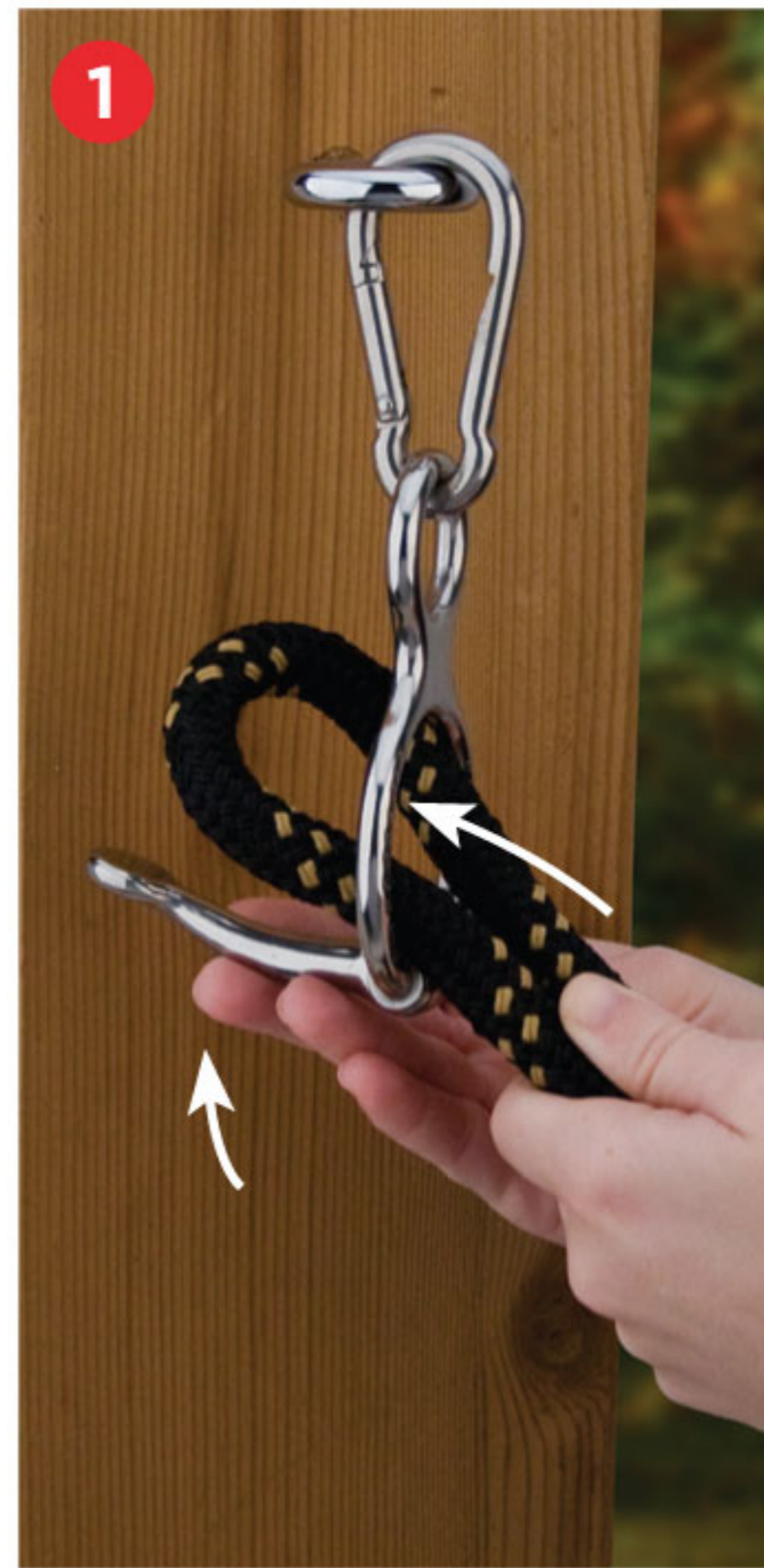

LEVEL 2 (MORE HOLD)

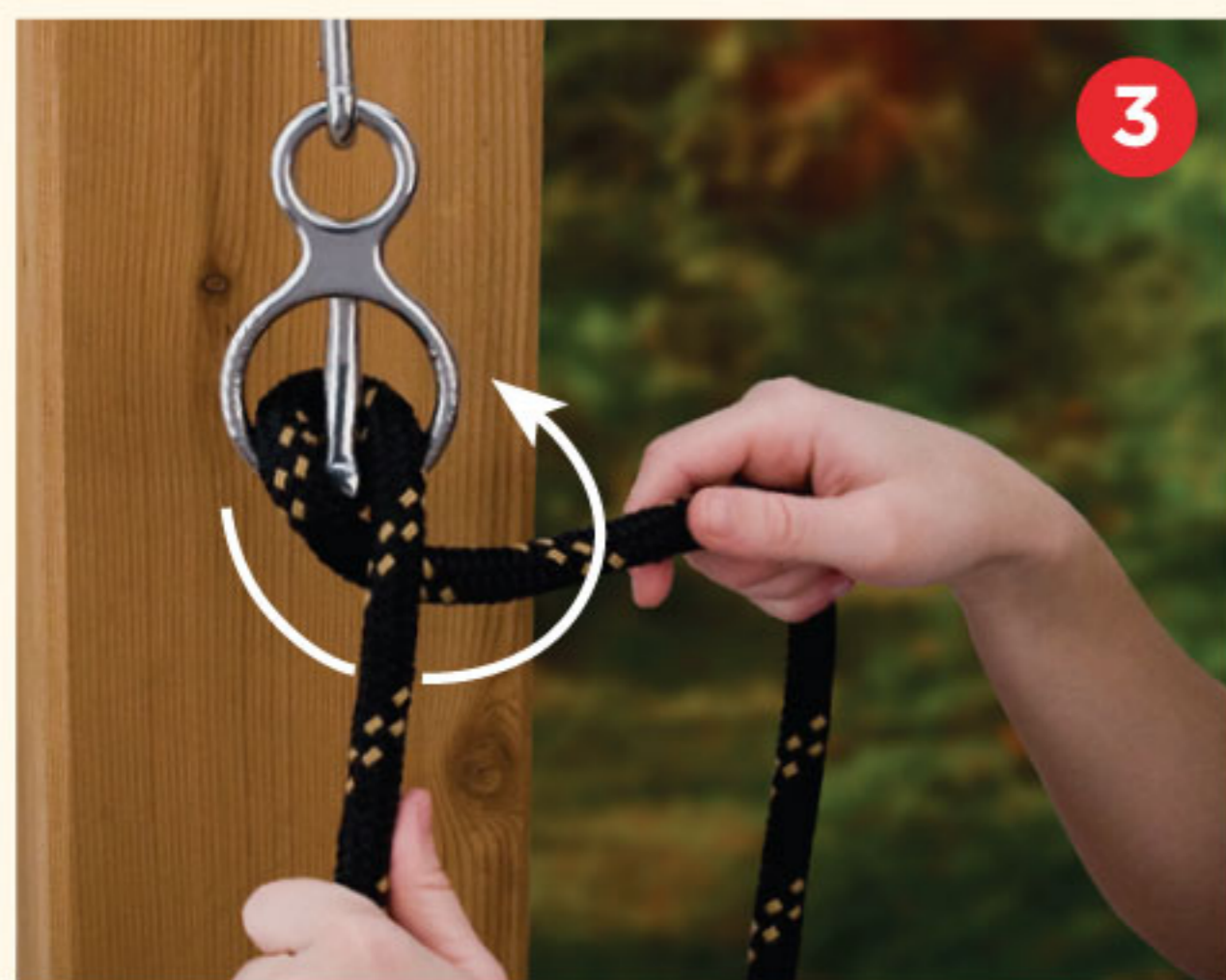

STEP 3 Starting with your lead rope tied (see fig. 3); bring loose end of lead rope underneath and behind the snap end attached to the horse

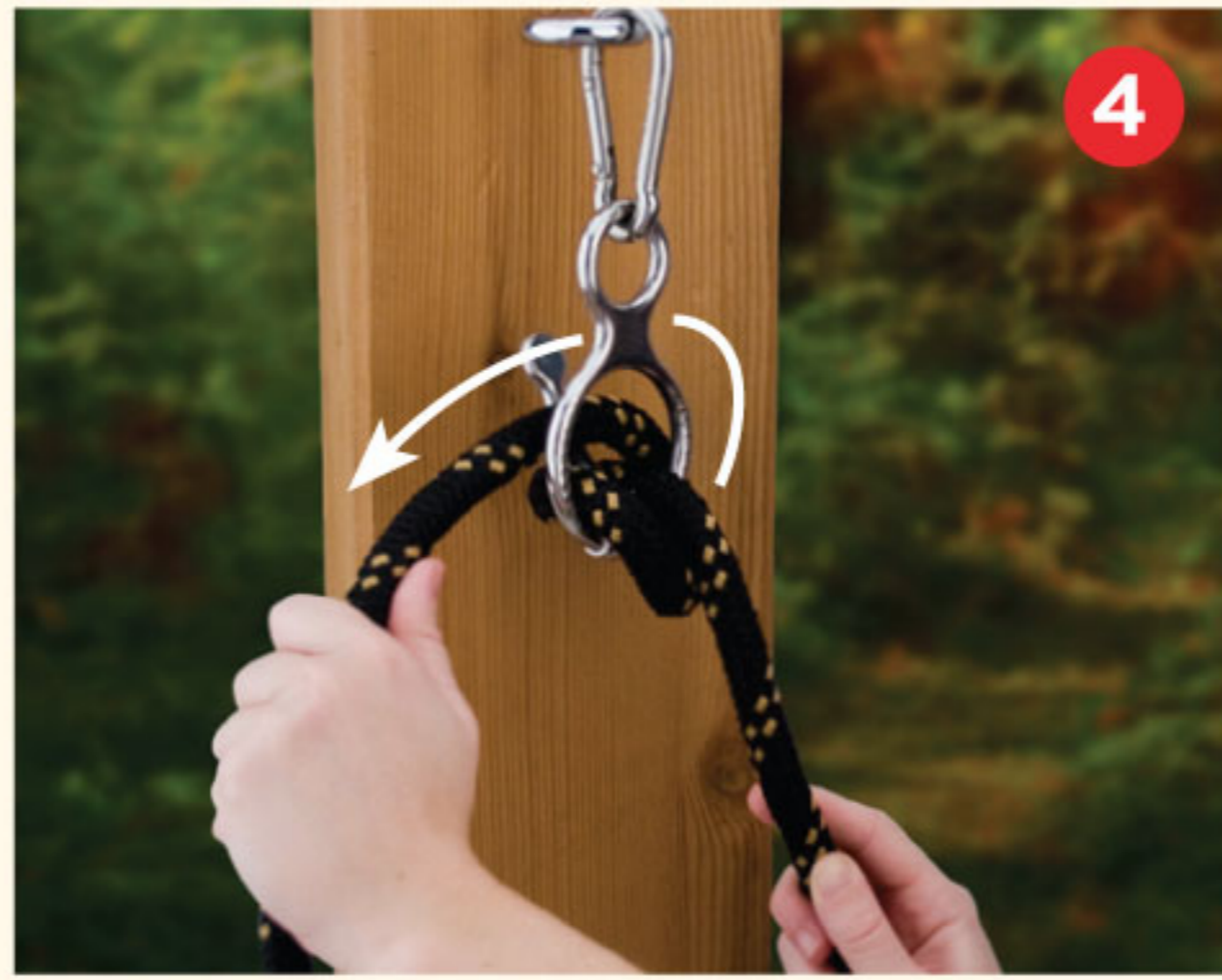

STEP 4 Push the Tie Ring tongue out and bring the loose end of lead rope up and behind the Tie Ring, then down over the tongue, making a circle.



STEP 5 Grasp the end of the lead rope that is attached to your horse and pull down to secure in place. Be sure to practice a few times before attempting with your horse.

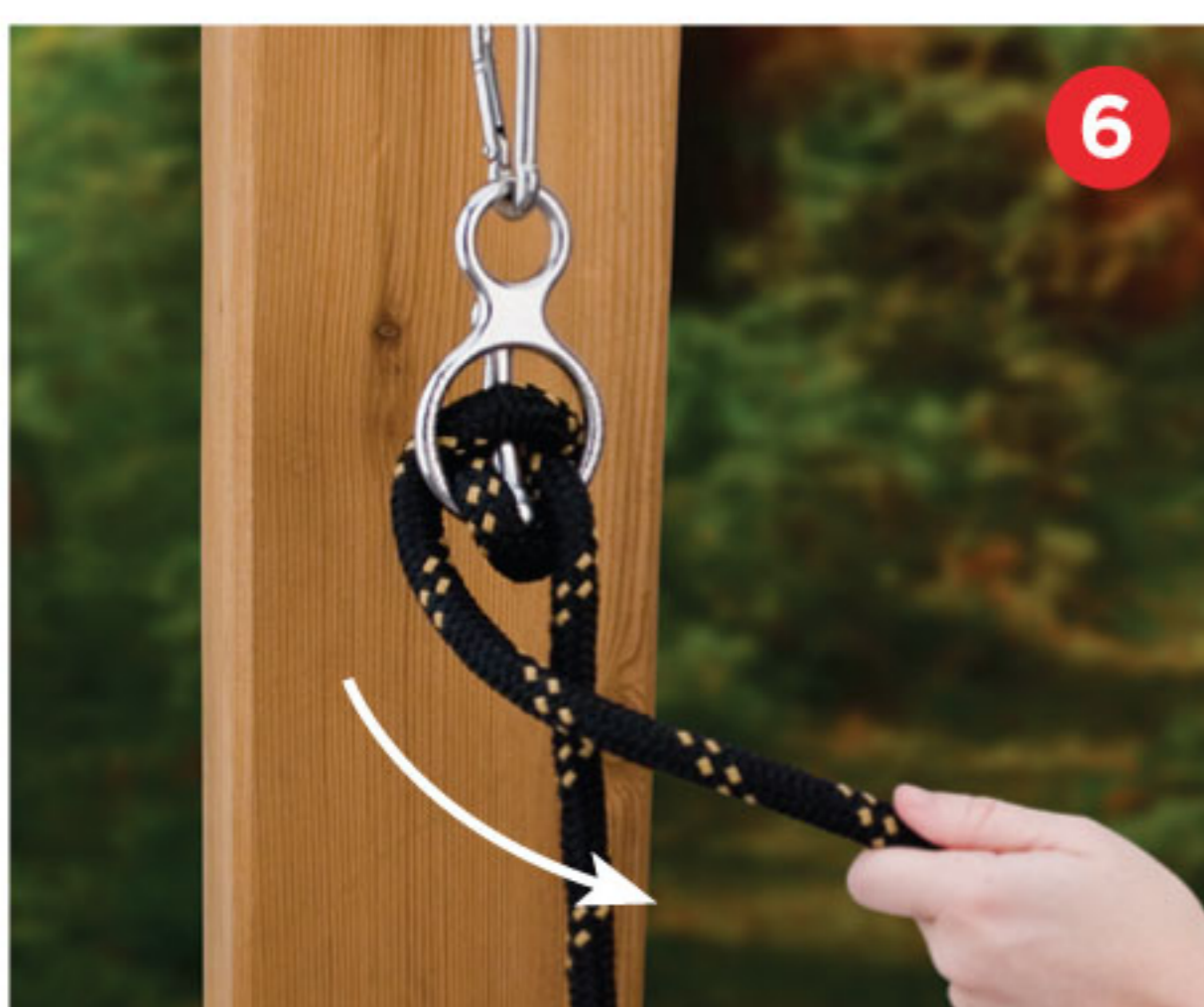

LEVEL 3 (MAXIMUM HOLD)

STEP 6 Starting with your lead rope tied at (see fig 5), grasp the tail end of the lead rope and toss it over the top of the lead rope that is attached to your horse. This creates the most hold possible while still allowing a release.

NOTE: if you can't pull the lead rope through the Tie Ring, you are probably using more hold than necessary to support your horse.